

STAGE 2 REMOVAL

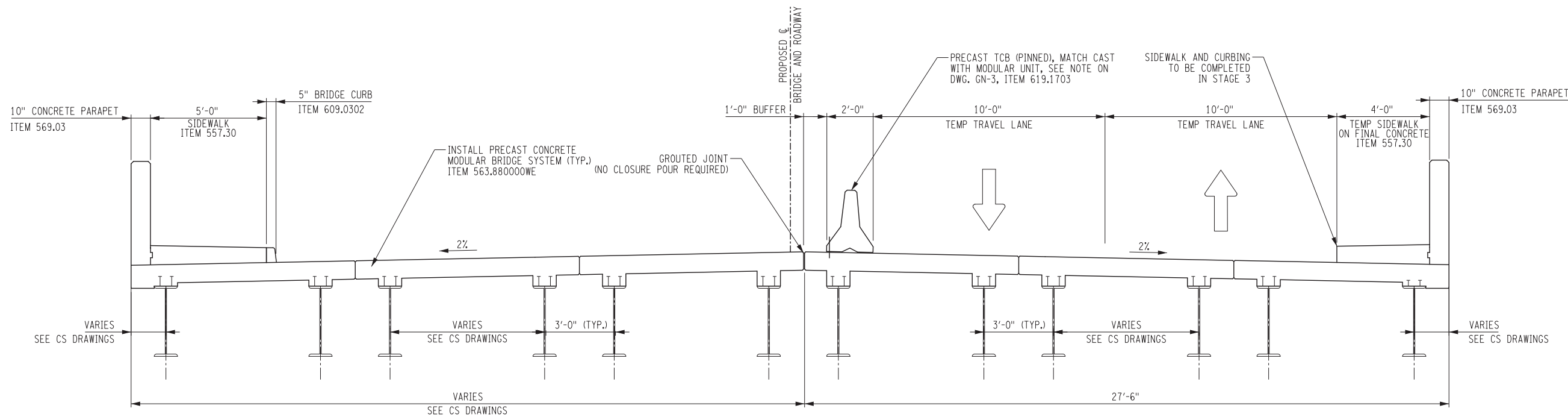

STAGE 2 CONSTRUCTION

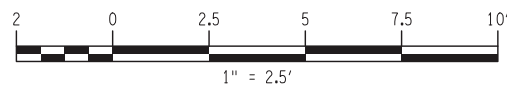

FILE NAME = L:\AP\090056-ashford\3_CADD\dgn\090056_CPH_SEC_MPT_02.dgn
 DATE/TIME = 12/16/2015 4:02:52 PM
 USER = usj004025

IN CHARGE OF: D.W.
 MADE BY: D.B.
 CHECKED BY: J.A.

WSP • SELLS
 Transportation & Infrastructure
 555 Pleasantville Road • Briarcliff Manor, NY 10510 • 914-747-1120
 www.wspells.com

REVISION NUMBER	DATE	MADE BY	APP'D BY	REVISION

RECORD DRAWING CERTIFICATION	
<input type="checkbox"/>	AS BUILT-CHANGES AS NOTED
<input type="checkbox"/>	AS BUILT-NO CHANGES
CONTRACTOR	
NAME _____	PROJECT COORDINATOR
SIGNATURE _____	SIGNATURE _____
TITLE _____	TITLE _____
DATE _____	DATE _____

WESTCHESTER COUNTY, NEW YORK
 DEPARTMENT OF PUBLIC WORKS AND TRANSPORTATION
 DIVISION OF ENGINEERING

REHABILITATION OF THE ASHFORD AVENUE BRIDGE
 (BIN 5348380) AND RAMP (BIN 534838A)
 WZTC - STAGE 2 MPT SECTION

CONTRACT NUMBER 09-547	DRAWING NUMBER MPS-2
SHEET NO. 17 OF 230	
SCALE: AS SHOWN DATE: JUNE 2015	
DPW FILE NO. 56-23-G-75-0	REV NO.

FILE NAME = L:\AP\090056-ashford\3_CADD\dgn\090056_CPH_MPT_04.dgn
 DATE/TIME = 12/16/2015 4:03:03 PM
 USER = usj04025

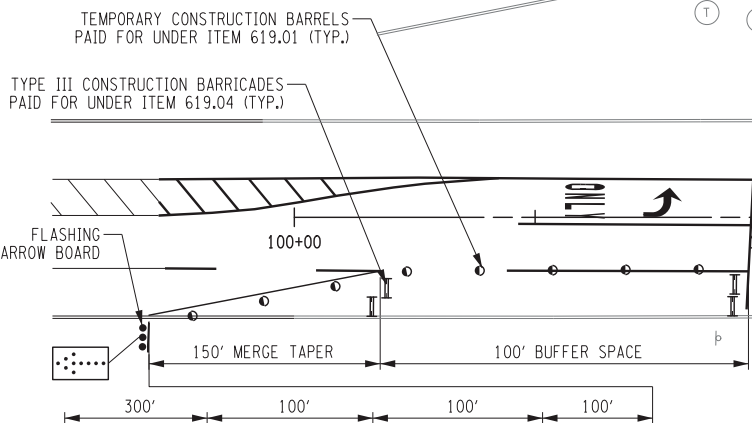
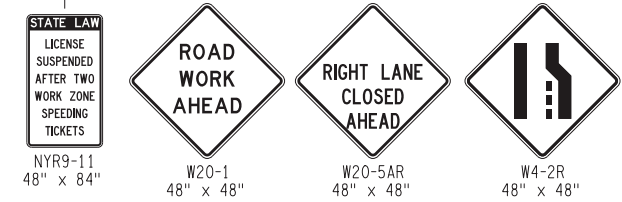
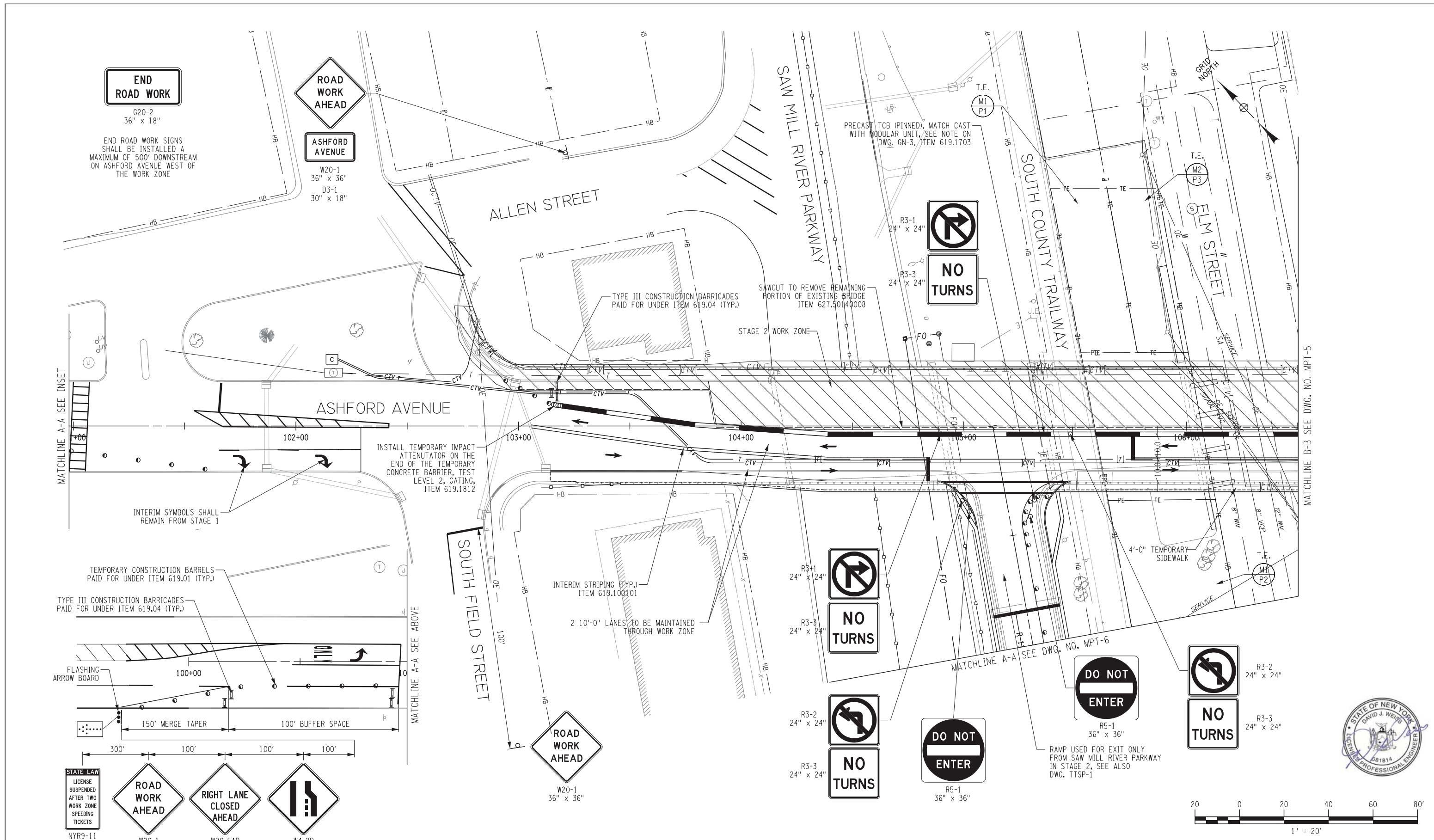

REVISION NUMBER	DATE	MADE BY	APP'D BY	REVISION

RECORD DRAWING CERTIFICATION	
<input type="checkbox"/>	AS BUILT-CHANGES AS NOTED
<input type="checkbox"/>	AS BUILT-NO CHANGES
CONTRACTOR	
PROJECT COORDINATOR	
NAME	NAME
SIGNATURE	SIGNATURE
TITLE	TITLE
DATE	DATE

WESTCHESTER COUNTY, NEW YORK DEPARTMENT OF PUBLIC WORKS AND TRANSPORTATION DIVISION OF ENGINEERING		CONTRACT NUMBER 09-547	DRAWING NUMBER MPT-4
REHABILITATION OF THE ASHFORD AVENUE BRIDGE (BIN 5348380) AND RAMP (BIN 534838A)		SHEET NO. 22 OF 230	SCALE: AS SHOWN DATE: JUNE 2015
WZTC - STAGE 2 MPT PLAN 1		DPW FILE NO. 56-23-G-80-0	REV NO.

WSP • SELLS
 Transportation & Infrastructure
 555 Pleasantville Road - Briarcliff Manor, NY 10510 *914-747-1120
 www.wsp-sells.com

IN CHARGE OF: D.W.
 MADE BY: D.B.
 CHECKED BY: J.A.

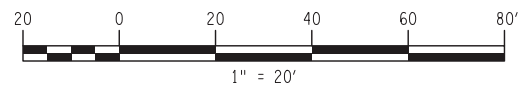

MATCHLINE A-A SEE INSET

MATCHLINE B-B SEE DWG. NO. MPT-5

MATCHLINE A-A SEE DWG. NO. MPT-6

END ROAD WORK
 G20-2
 36" x 18"
 END ROAD WORK SIGNS SHALL BE INSTALLED A MAXIMUM OF 500' DOWNSTREAM ON ASHFORD AVENUE WEST OF THE WORK ZONE

ROAD WORK AHEAD
 W20-1
 36" x 36"
 D3-1
 30" x 18"
ASHFORD AVENUE

NO TURNS
 R3-1
 24" x 24"
 R3-3
 24" x 24"

NO TURNS
 R3-1
 24" x 24"
 R3-3
 24" x 24"

NO TURNS
 R3-2
 24" x 24"
 R3-3
 24" x 24"

DO NOT ENTER
 R5-1
 36" x 36"

DO NOT ENTER
 R5-1
 36" x 36"
NO TURNS
 R3-2
 24" x 24"
 R3-3
 24" x 24"

RAMP USED FOR EXIT ONLY FROM SAW MILL RIVER PARKWAY IN STAGE 2; SEE ALSO DWG. TTSP-1

INSTALL TEMPORARY IMPACT ATTENUATOR ON THE END OF THE TEMPORARY CONCRETE BARRIER, TEST LEVEL 2, GATING, ITEM 619.1812

TYPE III CONSTRUCTION BARRICADES PAID FOR UNDER ITEM 619.04 (TYP.)

SAWCUT TO REMOVE REMAINING PORTION OF EXISTING BRIDGE ITEM 627.50140008

STAGE 2 WORK ZONE

INTERIM STRIPING (TYP.) ITEM 619.100101

2 10'-0" LANES TO BE MAINTAINED THROUGH WORK ZONE

INTERIM SYMBOLS SHALL REMAIN FROM STAGE 1

TEMPORARY CONSTRUCTION BARRELS PAID FOR UNDER ITEM 619.01 (TYP.)

TYPE III CONSTRUCTION BARRICADES PAID FOR UNDER ITEM 619.04 (TYP.)

FLASHING ARROW BOARD

150' MERGE TAPER 100' BUFFER SPACE

ROAD WORK AHEAD
 W20-1
 48" x 48"

RIGHT LANE CLOSED AHEAD
 W20-5AR
 48" x 48"

ROAD WORK AHEAD
 W4-2R
 48" x 48"

ROAD WORK AHEAD
 W20-1
 36" x 36"

PRECAST TCB (PINNED), MATCH CAST WITH MODULAR UNIT, SEE NOTE ON DWG. GN-3, ITEM 619.1703

ALLEN STREET

SAW MILL RIVER PARKWAY

SOUTH COUNTY TRAILWAY

ELM STREET

ASHFORD AVENUE

SOUTH FIELD STREET

GRID NORTH

HB

MATCHLINE A-A SEE ABOVE

FILE NAME = L:\AP\090056-ashford\3_CADD\dgn\090056_CPH_MPT_05.dgn
 DATE/TIME = 12/16/2015 4:03:05 PM
 USER = usj04025

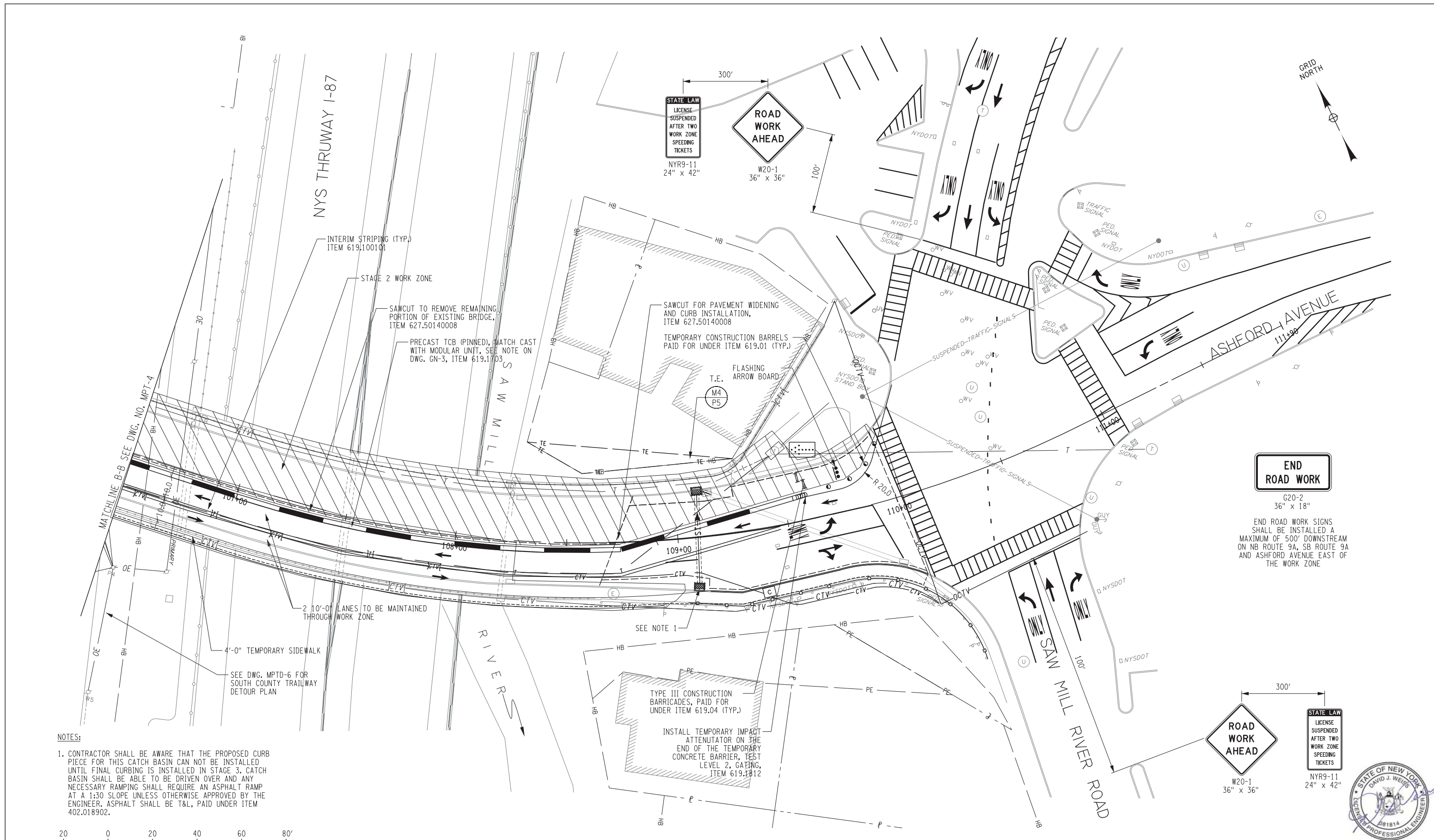

NOTES:
 1. CONTRACTOR SHALL BE AWARE THAT THE PROPOSED CURB PIECE FOR THIS CATCH BASIN CAN NOT BE INSTALLED UNTIL FINAL CURBING IS INSTALLED IN STAGE 3. CATCH BASIN SHALL BE ABLE TO BE DRIVEN OVER AND ANY NECESSARY RAMPING SHALL REQUIRE AN ASPHALT RAMP AT A 1:30 SLOPE UNLESS OTHERWISE APPROVED BY THE ENGINEER. ASPHALT SHALL BE T&L, PAID UNDER ITEM 402.018902.

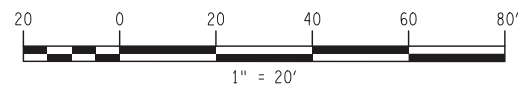

IN CHARGE OF: D.W.
 MADE BY: D.B.
 CHECKED BY: J.A.

WSP • SELLS
 Transportation & Infrastructure
 555 Pleasantville Road • Briarcliff Manor, NY 10510 • 914-747-1120
 www.wsp-sells.com

REVISION NUMBER	DATE	MADE BY	APP'D BY	REVISION

RECORD DRAWING CERTIFICATION

AS BUILT-CHANGES AS NOTED
 AS BUILT-NO CHANGES

CONTRACTOR		PROJECT COORDINATOR	
NAME	SIGNATURE	NAME	SIGNATURE
TITLE	DATE	TITLE	DATE

WESTCHESTER COUNTY, NEW YORK
 DEPARTMENT OF PUBLIC WORKS AND TRANSPORTATION
 DIVISION OF ENGINEERING

REHABILITATION OF THE ASHFORD AVENUE BRIDGE
 (BIN 5348380) AND RAMP (BIN 534838A)
 WZTC - STAGE 2 MPT PLAN 2

CONTRACT NUMBER	DRAWING NUMBER
09-547	MPT-5
SHEET NO. 23 OF 230	
SCALE: AS SHOWN	
DATE: JUNE 2015	
DPW FILE NO.	REV NO.
56-23-G- 81-0	



FILE NAME = L:\AP\090056-ashford\3_CADD\dgn\090056_CPH_MPT_06.dgn
 DATE/TIME = 12/16/2015 4:03:07 PM
 USER = usj04025

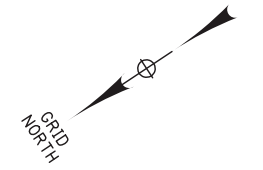
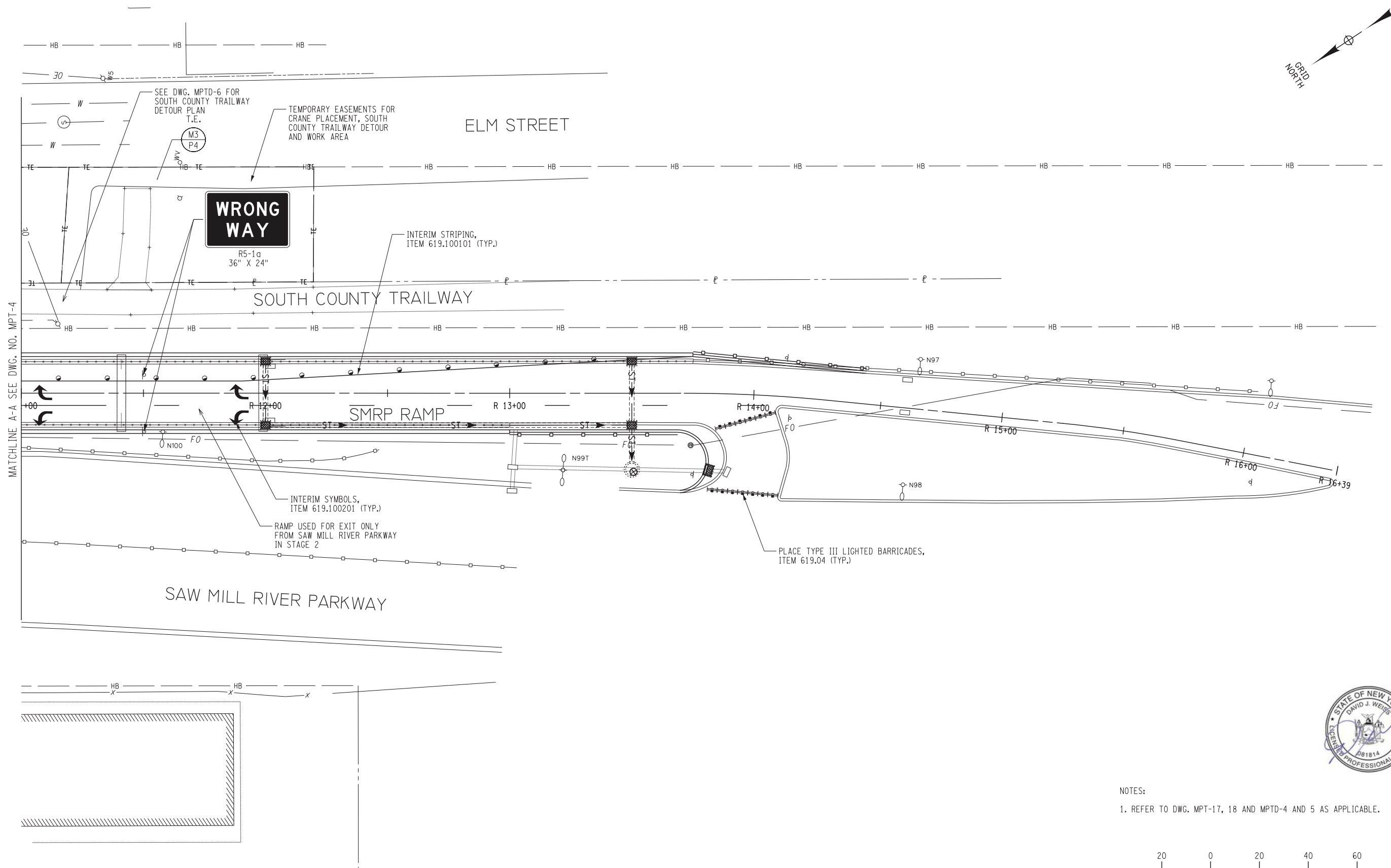

MATCHLINE A-A SEE DWG. NO. MPT-4



NOTES:
 1. REFER TO DWG. MPT-17, 18 AND MPTD-4 AND 5 AS APPLICABLE.

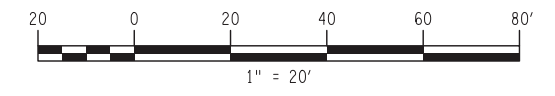

IN CHARGE OF: D.W.
 MADE BY: D.B.
 CHECKED BY: J.A.

WSP • SELLS
 Transportation & Infrastructure
 555 Pleasantville Road • Briarcliff Manor, NY 10510 • 914-747-1120
 www.wsp-sells.com

REVISION NUMBER	DATE	MADE BY	APP'D BY	REVISION

RECORD DRAWING CERTIFICATION	
<input type="checkbox"/> AS BUILT-CHANGES AS NOTED	
<input type="checkbox"/> AS BUILT-NO CHANGES	
CONTRACTOR	PROJECT COORDINATOR
NAME _____	NAME _____
SIGNATURE _____	SIGNATURE _____
TITLE _____ DATE _____	TITLE _____ DATE _____

WESTCHESTER COUNTY, NEW YORK
 DEPARTMENT OF PUBLIC WORKS AND TRANSPORTATION
 DIVISION OF ENGINEERING
 REHABILITATION OF THE ASHFORD AVENUE BRIDGE
 (BIN 5348380) AND RAMP (BIN 534838A)
 WZTC - STAGE 2 MPT PLAN 3

CONTRACT NUMBER 09-547	DRAWING NUMBER MPT-6
SHEET NO. 24 OF 230	
SCALE: AS SHOWN DATE: JUNE 2015	
DPW FILE NO. 56-23-G-82-0	REV NO.